

NOTES

GENERAL

1 IMAGE EXTRACT FROM CAPE
FARM MAPPER



© COPYRIGHT RESERVED

<div><div>P O Box 2825 Durbanville, 7551 Tel +27 21 949 2140 info@storey.co.za</div><div>STOREY ENG (PTY) LTD engineering • management • consulting</div></div>	client STEENBERG ESTATE PROPERTY COMPANY		title WORK EXTENT DAM AT NORTH ENTRANCE		
	project STEENBERG ESTATE DAMS				
	design P STOREY Pr Eng	date 2025-03-17	scale NTS	drawing no C23030/c/037	rev -



LAYOUT PLAN

1:250

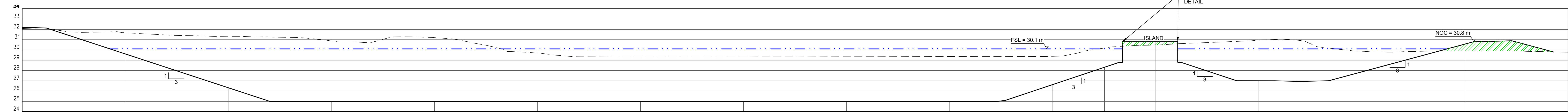

SECTION A - A

1:150

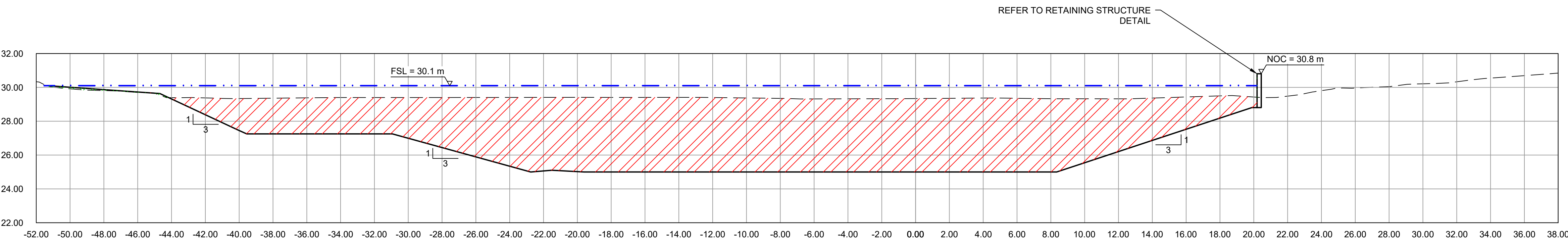

SECTION B - B

1:150

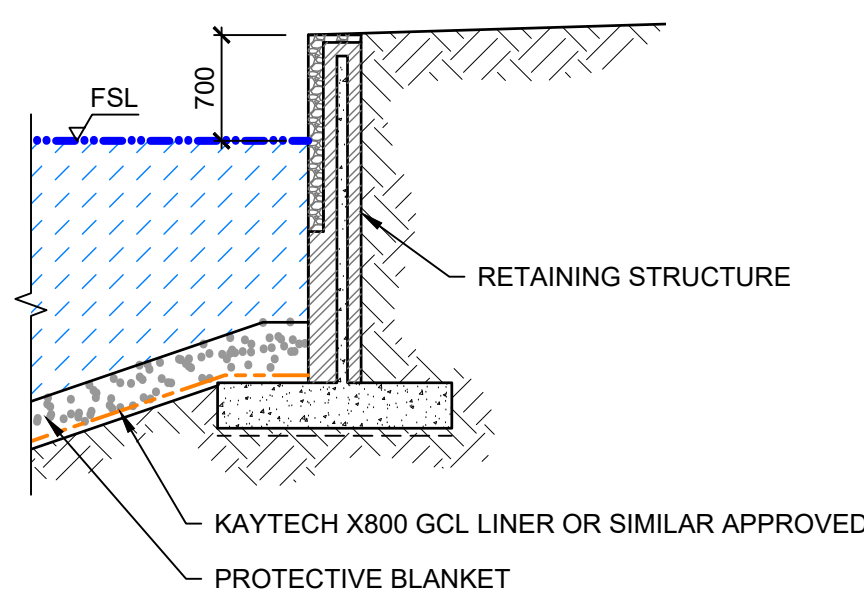

RETAINING STRUCTURE

1:50

VOLUMES
EXCESS CUT MATERIAL = 19 030 m³
WATER CAPACITY = 23 500m³

NOTES

GENERAL

- 1 ALL WORK SHALL BE IN ACCORDANCE WITH:
 - a) SANS 1200 - THE STANDARDIZED SPECIFICATION FOR WORKS OF CIVIL ENGINEERING CONSTRUCTION AS AMENDED
 - b) ALL RELEVANT PARTICULAR SPECIFICATIONS
 - c) ALL DRAWINGS
 - d) ALL ENGINEERS INSTRUCTIONS AND VARIATION ORDERS
- 2 PRIOR TO PUTTING ANY WORK IN HAND THE CONTRACTOR SHALL:
 - a) CHECK ALL DIMENSIONS, LEVELS, AND SETTING OUT INFORMATION, BOTH ON SITE AND ON THE DRAWINGS
 - b) IMMEDIATELY REPORT ANY DISCREPANCIES TO THE ENGINEER
 - c) OBTAIN WRITTEN CLARIFICATION OF THE DISCREPANCY
 - d) LOCATE ALL EXISTING SERVICES IN THE AREA OF THE WORKS
- 3 DRAWINGS SHALL NOT BE SCALED
- 4 NO ALTERATIONS SHALL BE MADE TO THE DESIGNS WITHOUT THE WRITTEN APPROVAL OF THE ENGINEER

ONLY DRAWINGS WITH NUMERAL REVISION IDENTIFIERS ARE APPROVED FOR CONSTRUCTION PURPOSES

© COPYRIGHT RESERVED		
REV	DESCRIPTION	DATE
F	ISSUED FOR APPROVAL	2025-06-06
E	LAYOUT AMENDED	2025-03-12
D	ISSUED FOR COMMENT	2025-03-21
C	LAYOUT PREVIEW AMENDED	2025-03-26
B	LAYOUT AMENDED	2025-02-18
A	ISSUED FOR DISCUSSION	2025-01-31

STEENBERG ESTATE
PROPERTY COMPANY

P O Box 2825
Durbanville 7501
Tel: +27 21 945 2140
info@storey.co.za

STOREY ENG (PTY) LTD
engineering management consulting

STEENBERG ESTATE DAMS
DAM LAYOUT NORTH
ENTRANCE - OPTION 5

Design: P O Storey Pr Eng
Drawn: P O Storey Pr Eng

1: GERMISHUYS
AS SHOWN

2025-06-06 C23030/c/035 F